

2022	1	1	2022	12	31			
<hr/>								
				198		17	1701	
<hr/>								
2023	5	24						

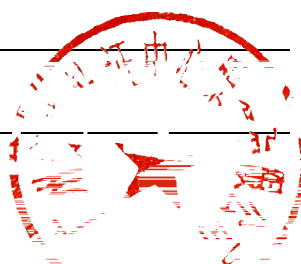

1.

1.1

<u>2022.1.1</u>	<u>2022.12.31</u>
<hr/>	<hr/>
<hr/>	<hr/>
<hr/>	<hr/>

1.2

<u>GHG</u>
<hr/>
<hr/>

- SZDB/Z 69
- SZDB/Z 70
-
- ---

- 5% 1
- 4% 1 5
- 3% 5 10
- 2% 10 100
- 1%

1.3

<hr/>	<hr/>	<hr/>	<hr/>
	198	17	1701

15-17

		_____	_____
		_____	_____
		_____	_____

- (3.1.1)
- (3.1.2)
- (6)

1.4

- 2023 05 18 2023 05 18
- 2023 05 24 2023 05 24
- 2023 05 24 2023 05 24
- 2023 05 24 2023 05 24

	57.34
	385.17

2.1

1

2.2

2

2.3

3.

3.1

3.1.1



8

							tCO _{2e}
		/		t			
1				t			
2				t			
4							
							385.17

$$= \left(\frac{\text{CO}_2\text{e}_{2022} - \text{tCO}_2\text{e}_{2021}}{\text{CO}_2\text{e}_{2021}} \right) * 100\%$$

2022
CO_{2e}
2022

2021
tCO_{2e}
2021

20%

-93%

3.6

SZDB/Z 70-2018

3.7

4.

夏勇

2023/5/24

黄倩茹

2023/5/24

何知深

2023/5/24

1

/

198

17 1702

2

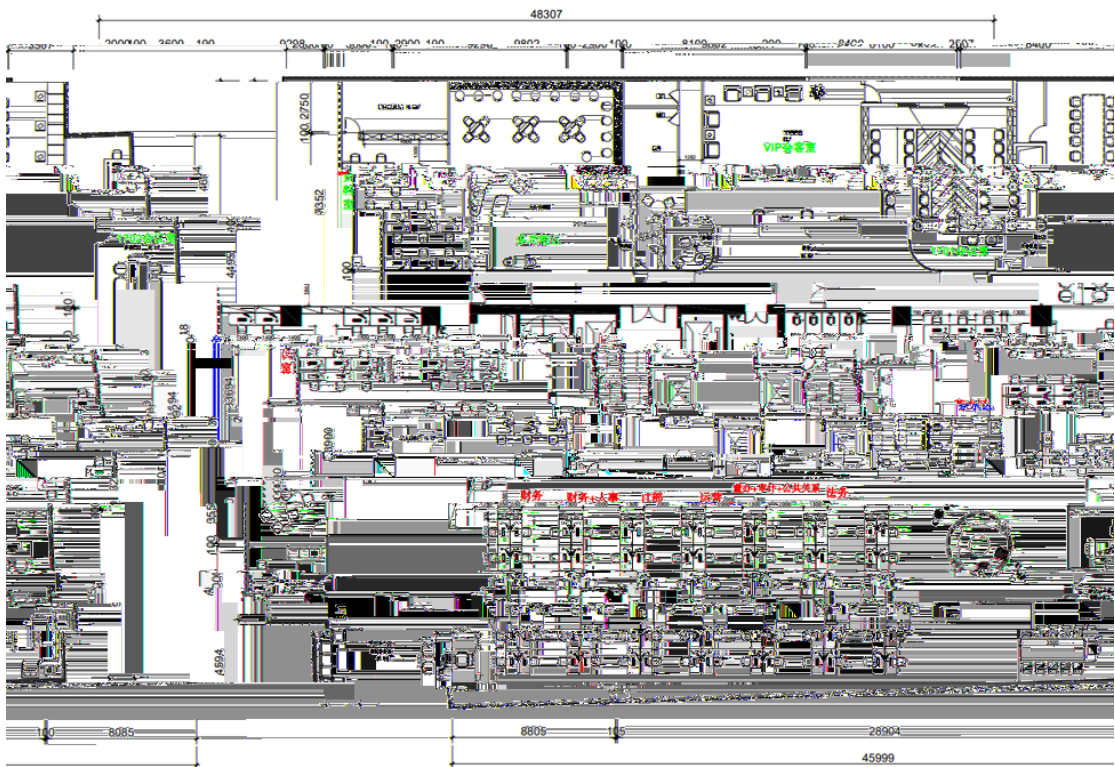

17

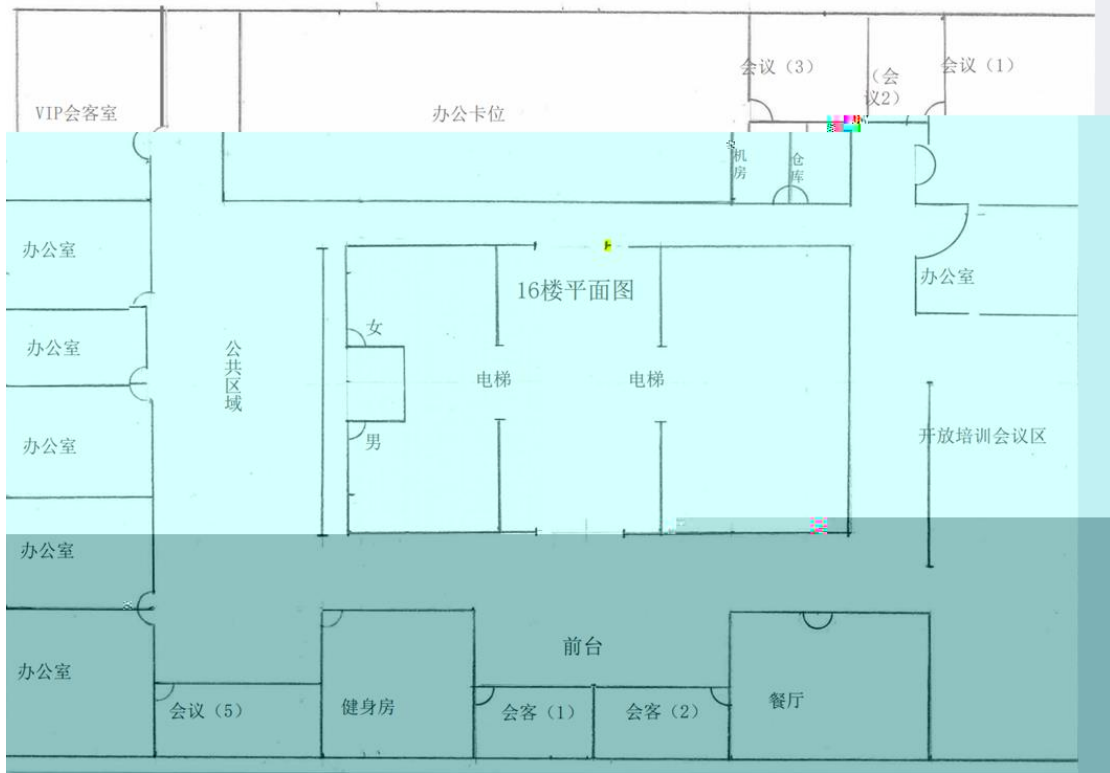

16

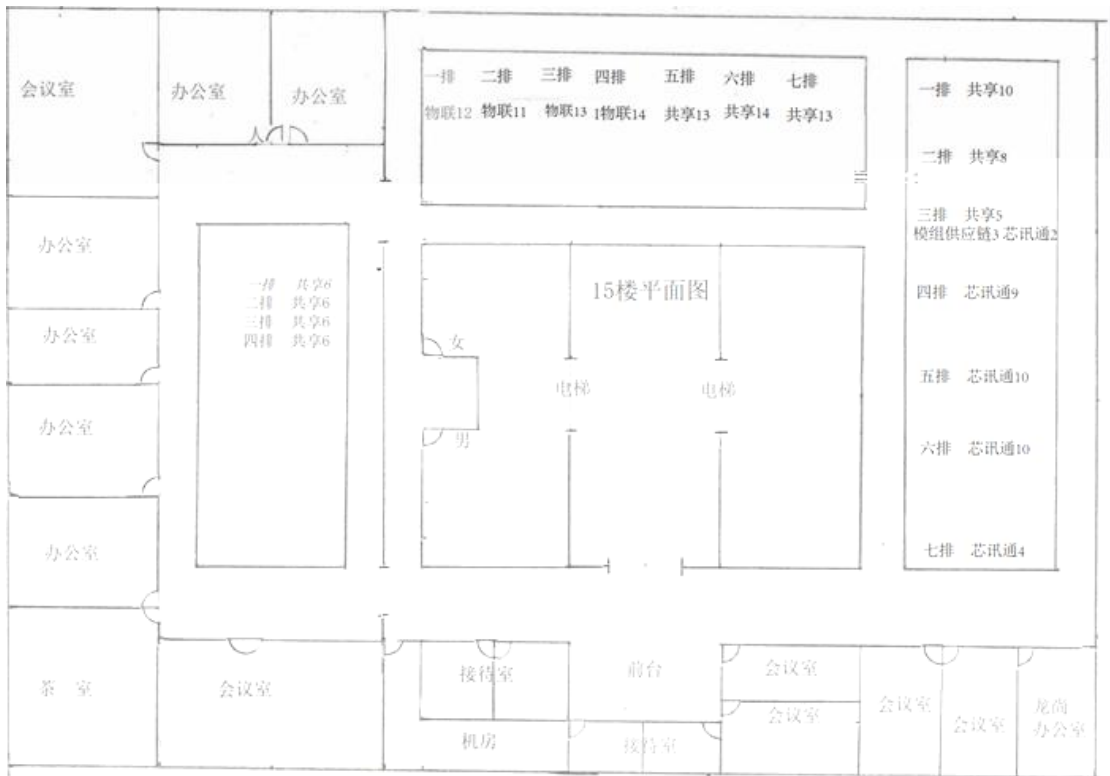

15

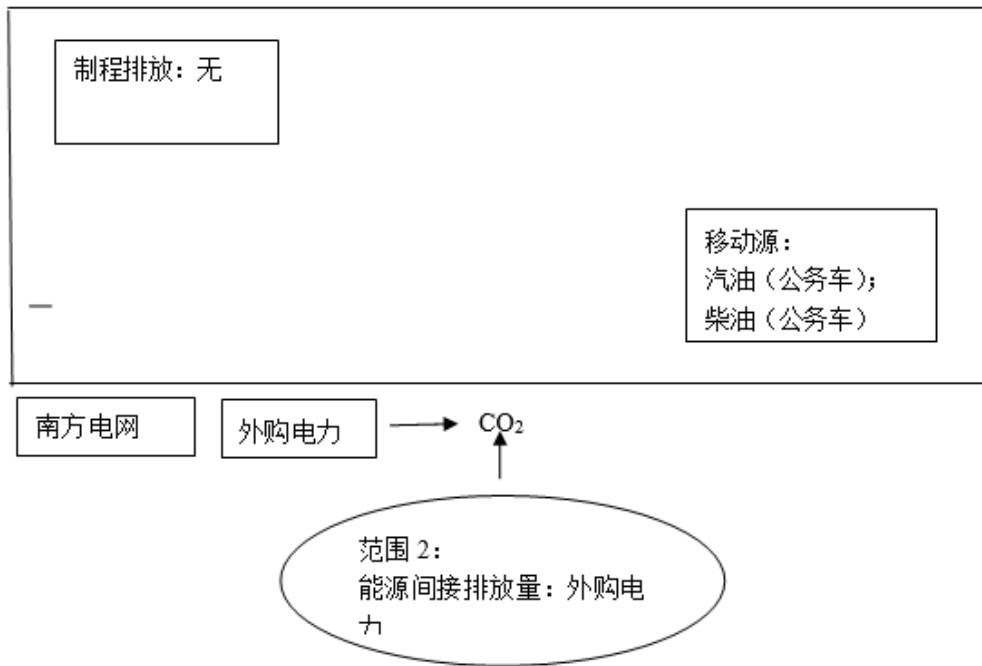

1

2

3

4

/