

2023 1 1 2023 12 31

198 17 1701

2024 5 8

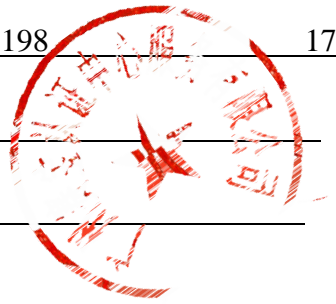

1.

1.1

	<u>202 .1.1</u>
<u>202 .12.31</u>	
/	
	<u>392</u>

1.2

5% 1

4% 1 5

3% 5 10

2% 10 100

1% 100

1.3

	<u>198</u>	<u>17</u>	<u>1701</u>
	"	"	
<u>15-17</u>			
	<u>4</u>		<u>198</u>
<u>15 1501</u>		<u>15 1502</u>	

15 1503 _____ 15 1504 _____

4 _____

_____ 2023 2022 _____

1.4

2.

- _____
- _____
- _____
- _____

2.3

3.

3.1

3.1.1

3.1.2

3.2

3.

3. .1

3. .2

202

tCO2e

202

202

tCO2e

%

4.

— = — —

字

202 / /

刘静

202 / /

刘静

202 / /

198

17 1701

" "

15-17

4

198

15 1501

15 1502

15 1503

15 1504

4

2023

2022

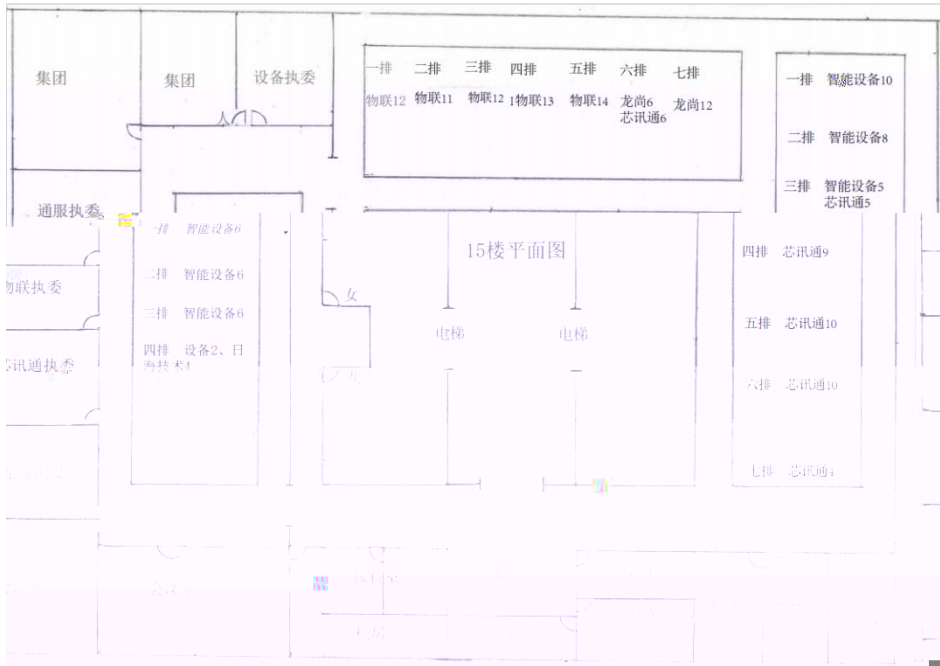

						3000
			198 B 1503		198 B 1503	